

Perfil Longitudinal: LINEA ELECTRICA 1
Escala - V: 200 H:1.000

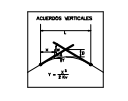
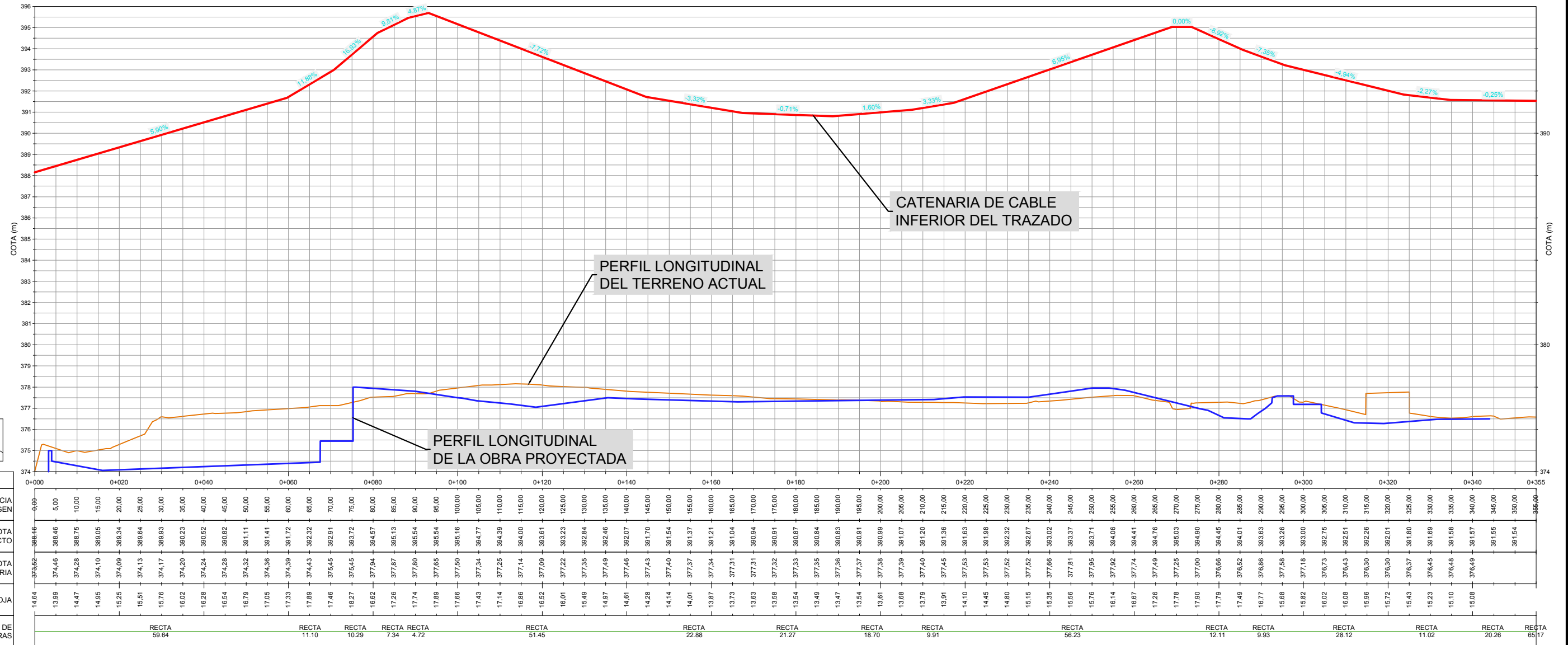

P.K.	DISTANCIA AL ORIGEN	COTA PROYECTO	COTA CATENARIA	COTA ROJA	DIAGRAMA DE CURVATURAS
0+000	0.00	388.16	375.62	14.64	
5.00	5.00	388.46	374.46	13.99	RECTA 59.64
10.00	10.00	388.75	374.28	14.47	
15.00	15.00	389.05	374.10	14.95	
20.00	20.00	389.34	374.08	15.25	
25.00	25.00	389.64	374.13	15.51	
30.00	30.00	389.93	374.17	15.76	
35.00	35.00	390.23	374.20	16.02	
40.00	40.00	390.52	374.24	16.28	
45.00	45.00	390.82	374.28	16.54	
50.00	50.00	391.11	374.32	16.79	
55.00	55.00	391.41	374.36	17.05	
60.00	60.00	391.72	374.39	17.33	
65.00	65.00	392.32	374.43	17.89	RECTA 11.10
70.00	70.00	392.91	375.45	17.46	RECTA 10.29
75.00	75.00	393.72	375.45	18.27	RECTA 7.34
80.00	80.00	394.57	377.94	16.62	RECTA 4.72
85.00	85.00	395.13	377.87	17.26	
90.00	90.00	395.54	377.80	17.74	
95.00	95.00	395.54	377.65	17.89	
100.00	100.00	395.16	377.50	17.66	
105.00	105.00	394.77	377.34	17.43	
110.00	110.00	394.39	377.25	17.14	
115.00	115.00	394.00	377.14	16.86	
120.00	120.00	393.61	377.09	16.52	RECTA 51.45
125.00	125.00	393.23	377.22	16.01	
130.00	130.00	392.84	377.35	15.49	
135.00	135.00	392.46	377.49	14.97	
140.00	140.00	392.07	377.46	14.61	
145.00	145.00	391.70	377.43	14.28	
150.00	150.00	391.54	377.40	14.14	
155.00	155.00	391.37	377.37	14.01	
160.00	160.00	391.21	377.34	13.87	
165.00	165.00	391.04	377.31	13.73	
170.00	170.00	390.94	377.31	13.63	
175.00	175.00	390.91	377.32	13.58	
180.00	180.00	390.87	377.33	13.54	
185.00	185.00	390.84	377.35	13.49	
190.00	190.00	390.83	377.36	13.47	
195.00	195.00	390.91	377.37	13.54	
200.00	200.00	390.99	377.38	13.61	
205.00	205.00	391.07	377.39	13.68	
210.00	210.00	391.20	377.40	13.79	
215.00	215.00	391.36	377.45	13.91	
220.00	220.00	391.63	377.53	14.10	
225.00	225.00	391.98	377.53	14.45	
230.00	230.00	392.32	377.52	14.80	
235.00	235.00	392.67	377.52	15.15	
240.00	240.00	393.02	377.66	15.35	
245.00	245.00	393.37	377.81	15.56	
250.00	250.00	393.71	377.95	15.76	
255.00	255.00	394.06	377.92	16.14	
260.00	260.00	394.41	377.74	16.67	
265.00	265.00	394.76	377.49	17.26	
270.00	270.00	395.03	377.25	17.78	
275.00	275.00	394.90	377.00	17.90	
280.00	280.00	394.45	376.66	17.79	
285.00	285.00	394.01	376.52	17.49	
290.00	290.00	393.63	376.86	16.77	
295.00	295.00	393.26	377.58	15.68	
300.00	300.00	393.00	377.18	15.62	
305.00	305.00	392.75	376.73	16.02	
310.00	310.00	392.51	376.43	16.08	
315.00	315.00	392.26	376.30	15.86	
320.00	320.00	392.01	376.30	15.72	
325.00	325.00	391.80	376.37	15.43	
330.00	330.00	391.69	376.45	15.23	
335.00	335.00	391.58	376.48	15.10	
340.00	340.00	391.57	376.48	15.08	
345.00	345.00	391.55	391.55	15.00	
350.00	350.00	391.54	391.54	15.00	
355.00	355.00	391.54	391.54	15.00	RECTA 65.17